

adam,
the [first] man,
the chair.





adam

The Creation of Adam by Michelangelo, c. 1512



According to the creation myth of the Abrahamic religions, he was the first man. Adam and his wife Eve were expelled from a Garden of Eden for eating the fruit of a tree forbidden by God.

The word adam is also used in the Bible as a pronoun, individually as "a human" and in a collective sense as "mankind". "adam" chair is designed ergonomically and imitates a human figure.

The adam chair design is inspired by stories of Adam, the first man to humanistic criteria of renaissance and human-scale lessons of Modern architecture.

A "chair" is the closest object to the human body among the furniture pieces. With this approach, "adam" is designed to embrace the user's body intimately.

This could be done with the help of material: plywood, as it can form complex surfaces continuously.

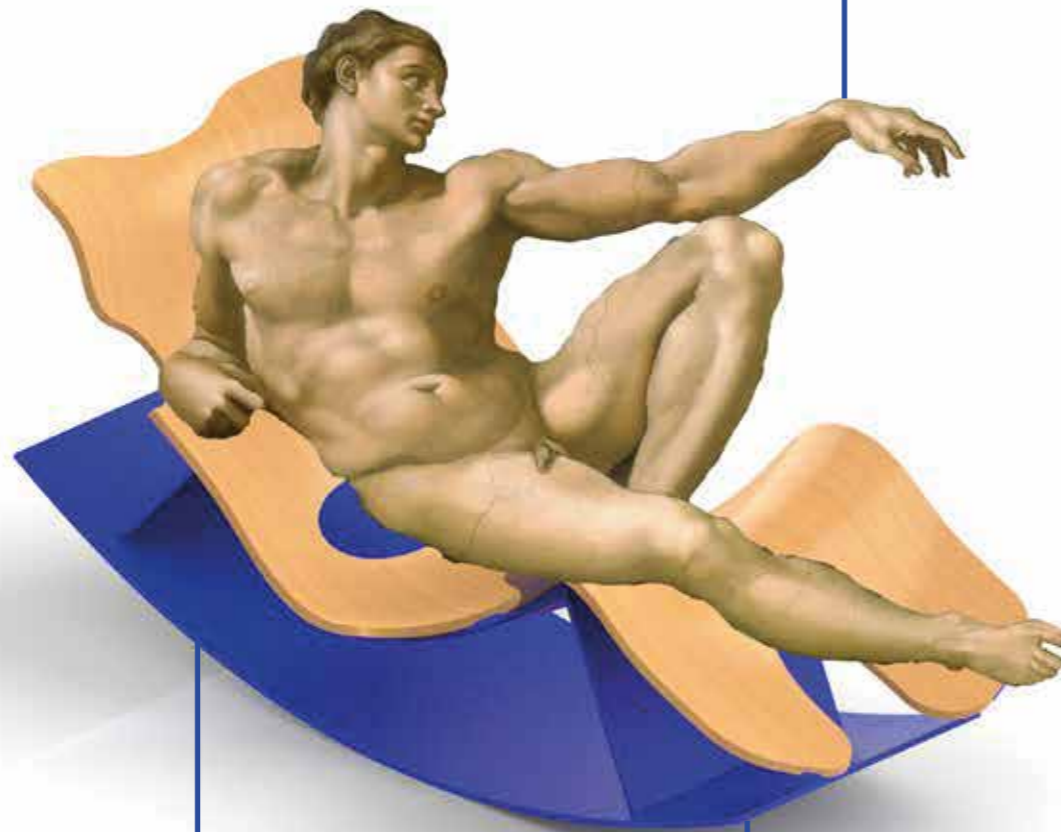

adam, the chair

The Modulor Man by Le Corbusier, 1900

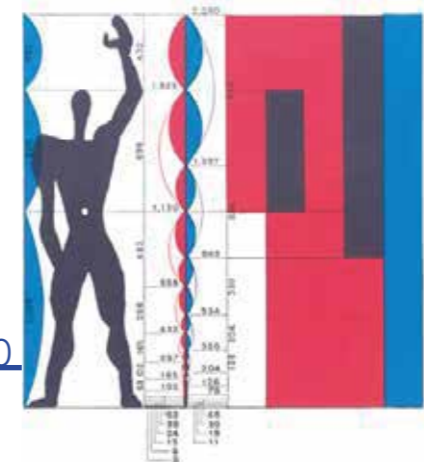

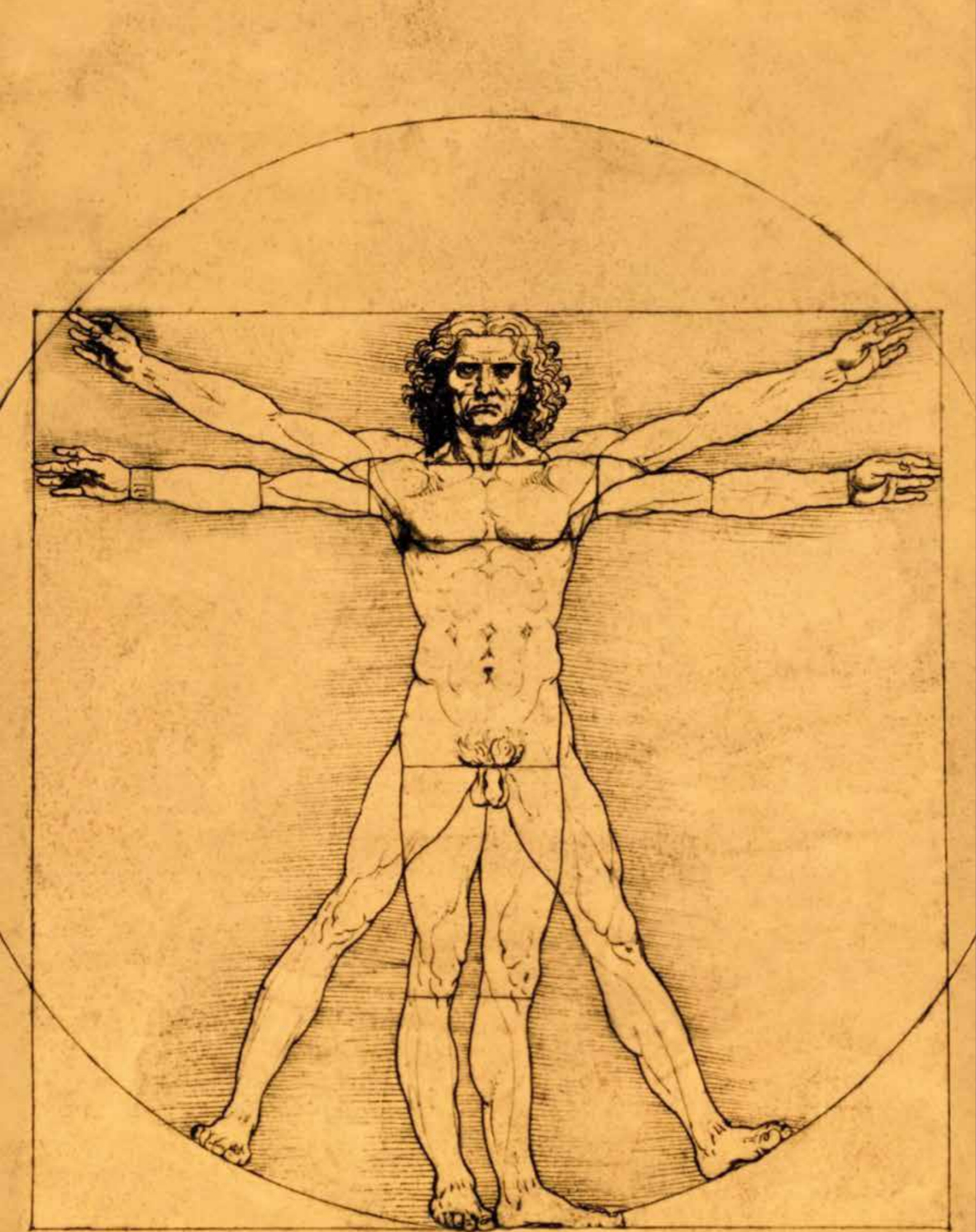

Leonardo da Vinci's Vitruvian Man (c. 1490) shows the correlations of ideal human body proportions with geometry described by the ancient Roman architect Vitruvius in his *De Architectura*. Vitruvius described the human figure as being like the principal source of proportion among the Classical orders of architecture.

”



adam

adam

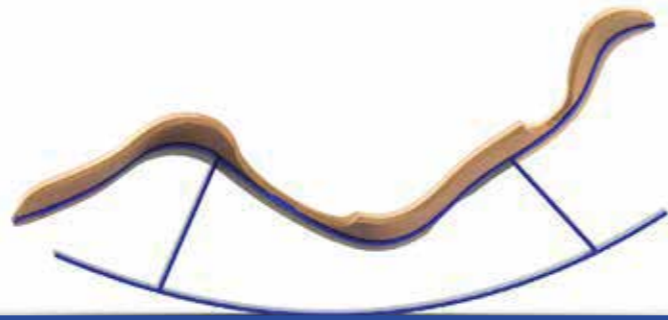



adam

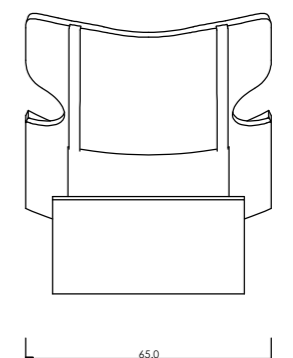
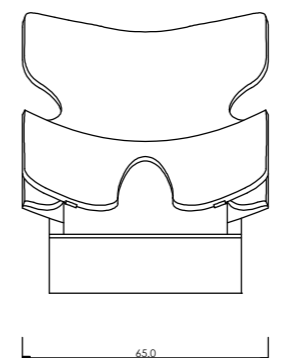
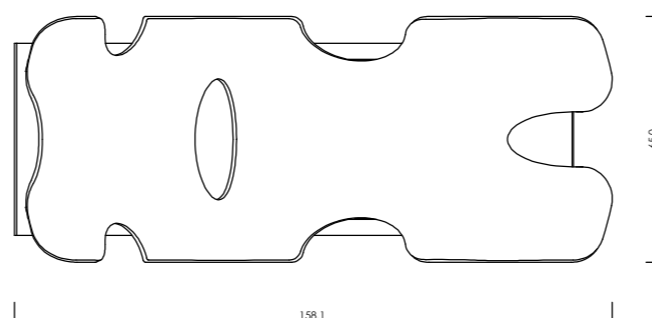
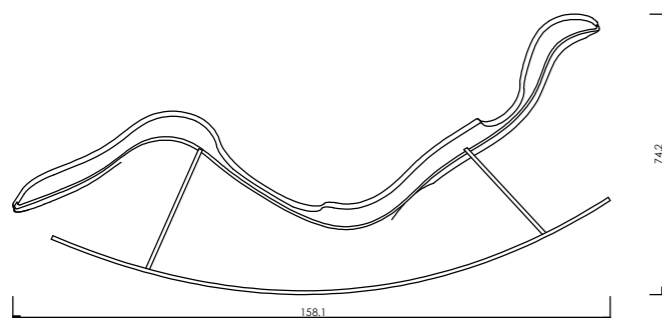

adam

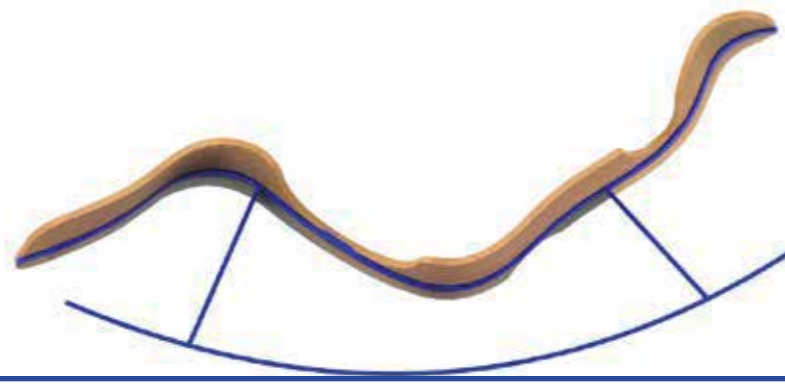

seating shell: plywood

fixing structure: electrostatic coated metal

rocking structure: electrostatic coated metal

welding joints

rocking structure: electrostatic coated metal

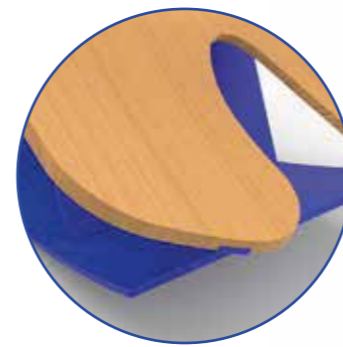
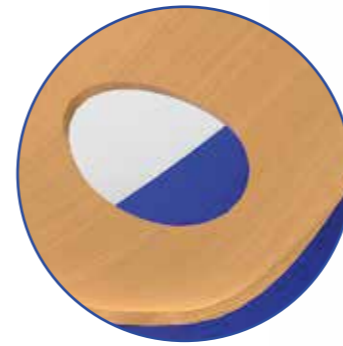
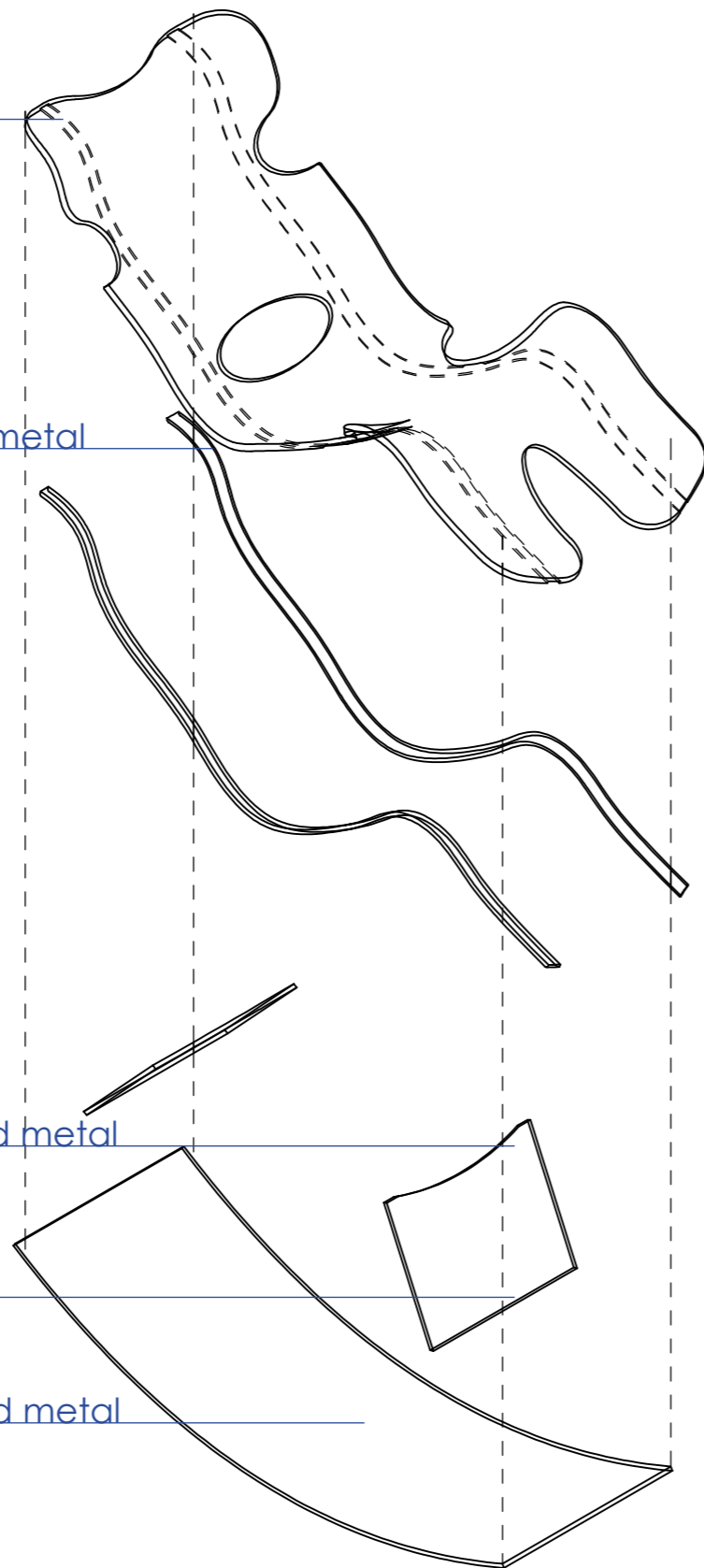

adam

adam

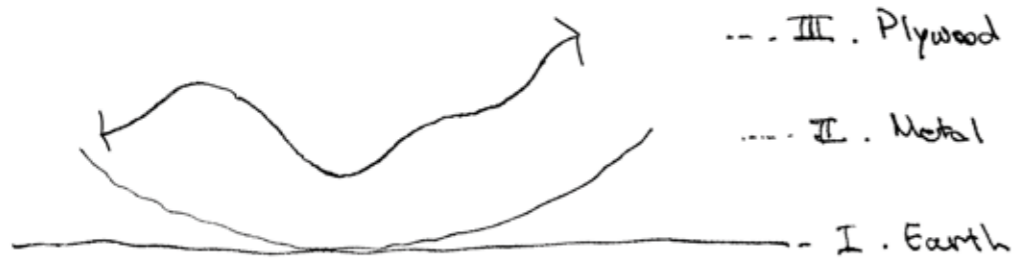
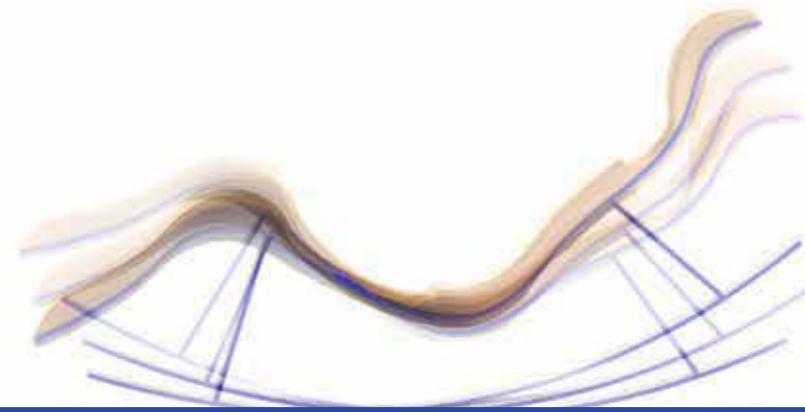

plywood

metal

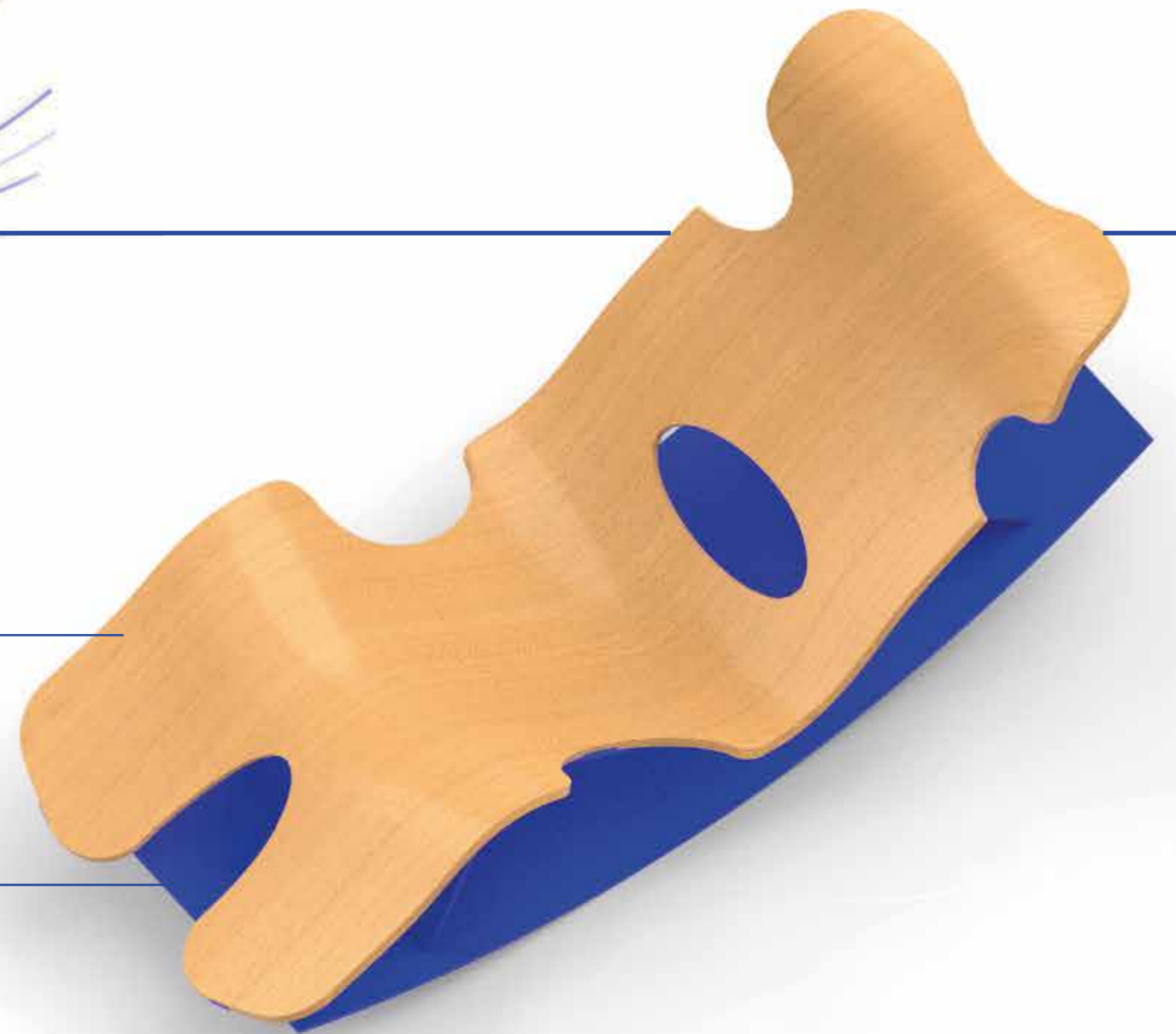

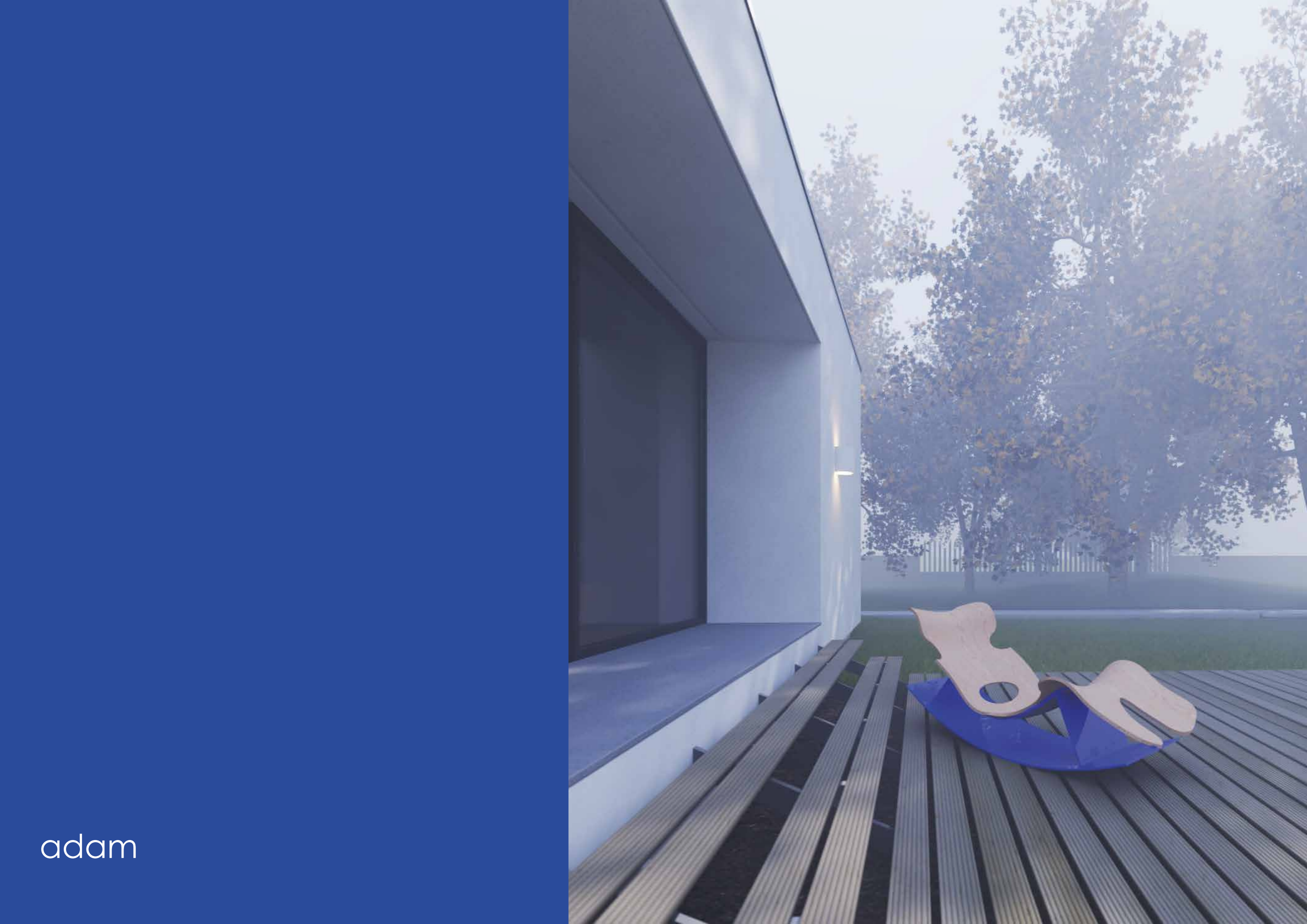

adam



adam

hossein khorassani

designer



27
tehran, iran

m.arch in architecture | college of fine arts | tehran university
member of HAMOUN design studio since 2017

instagram: @hossein.khorassani
website: www.hamounart.com